

# HDMI COUPLER INSTALLATION INSTRUCTIONS

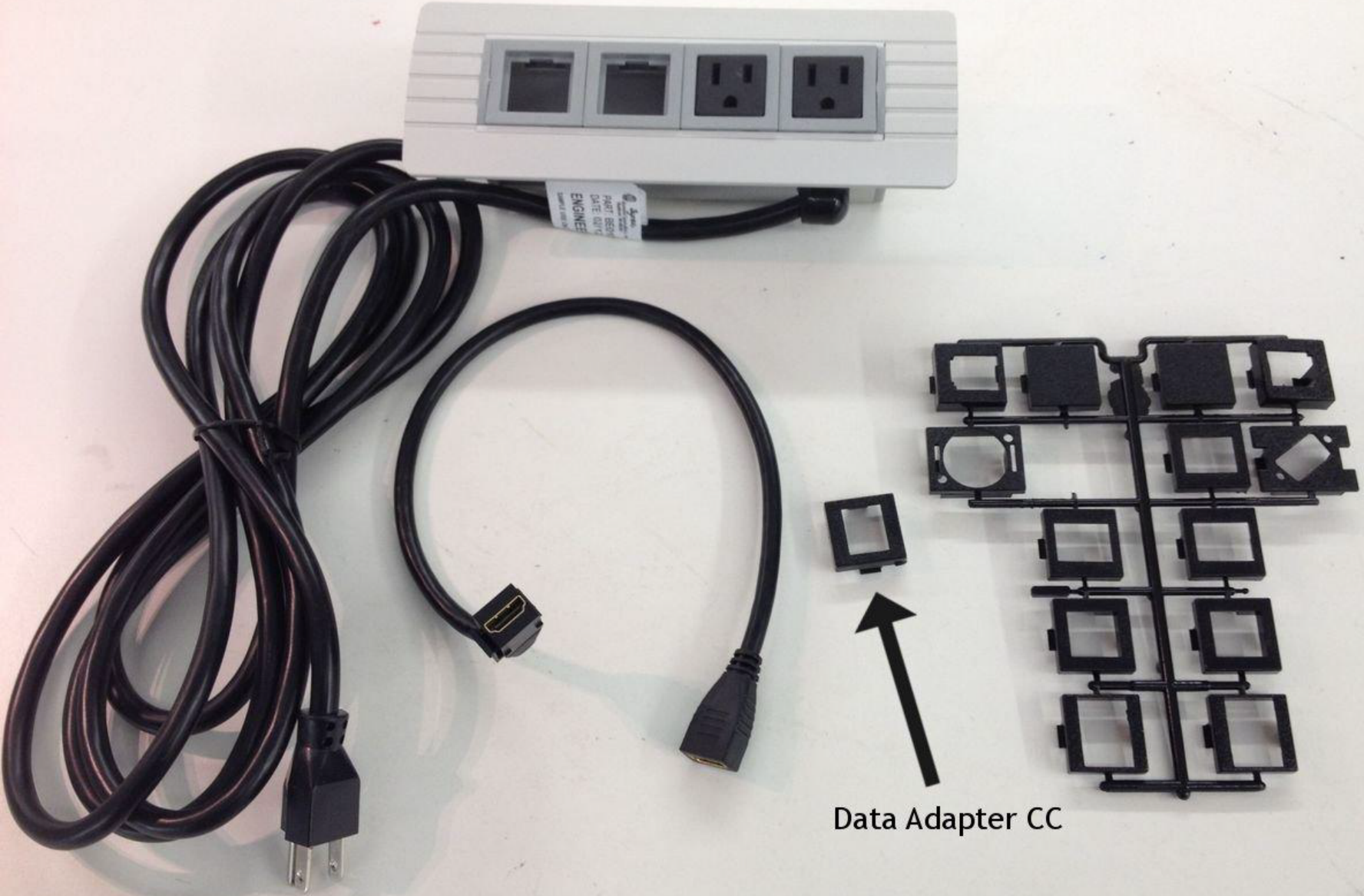

Data Adapter CC

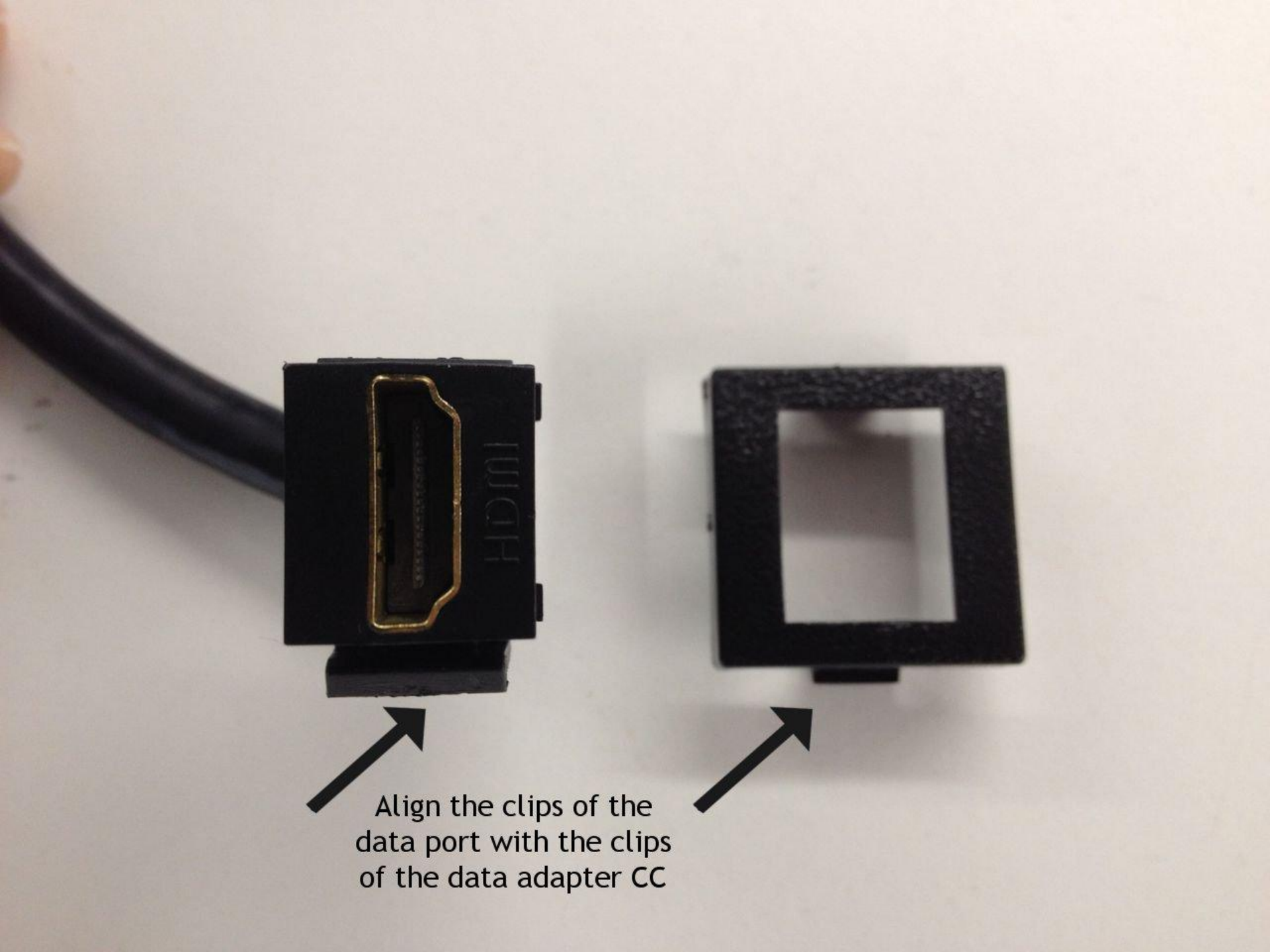

Align the clips of the data port with the clips of the data adapter CC

Position one edge of the data adapter CC below the clip of the data port



Press downward  
on data adapter  
CC until it clicks  
into place.



Feed the opposite end of the cord through the opening of the accessory.

Then align the clip of the data adapter CC with the notch in the opening of the accessory.

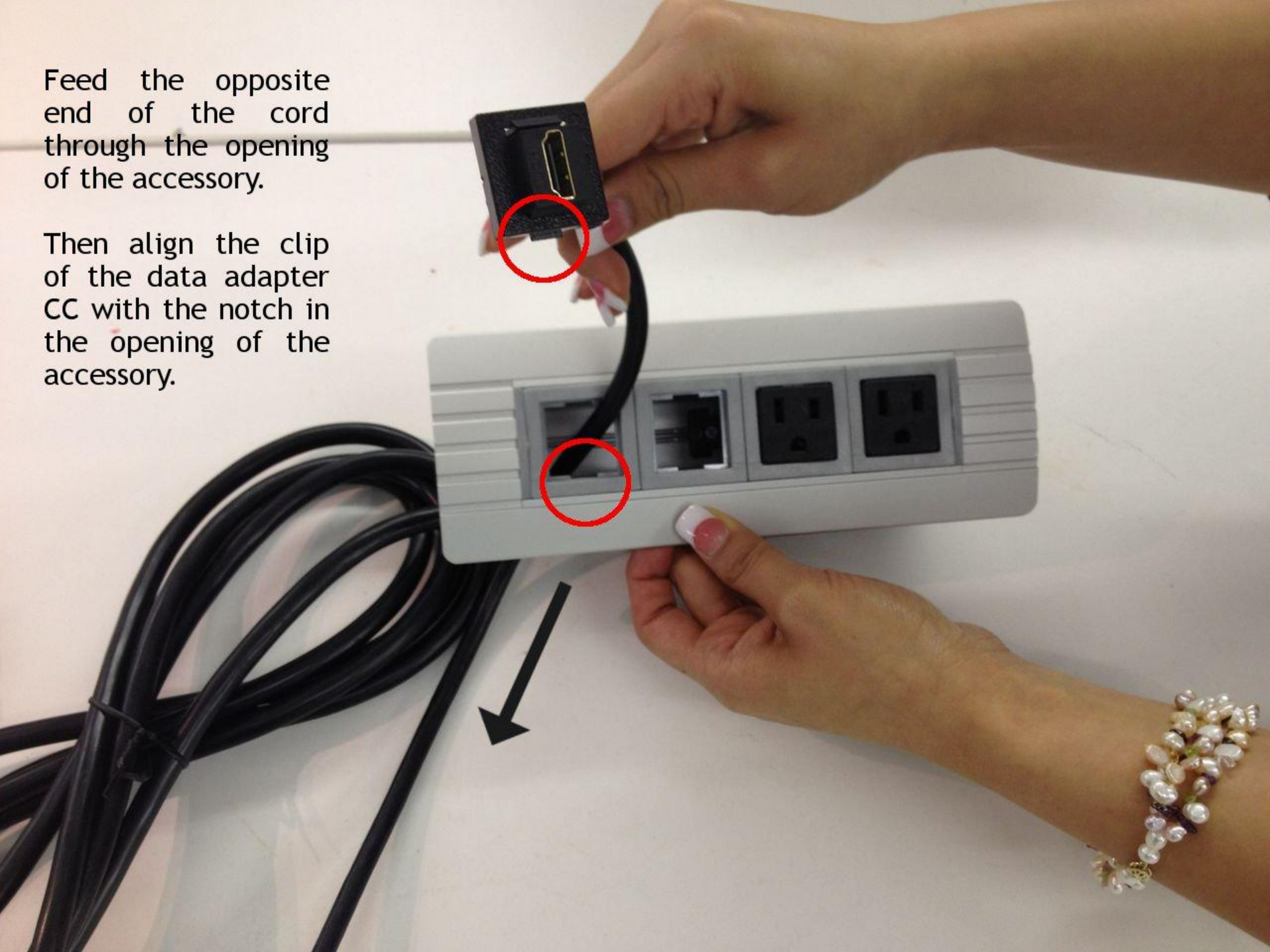

Angle the data adapter into the opening and press downward until it snaps into place, flush with the face of the accessory.



Finished Orientation

